

VALVOLA A SFERA MONOBLOCCO MICROFUSA

MONOBLOC BALL VALVE



VALVOLE INDUSTRIALI
INDUSTRIAL VALVES

SLE
120

NOTE COSTRUTTIVE:

Passaggio totale.
Attacchi BSP.
Pressione: 63 bar
Temperatura esercizio: -25°C / + 180°C

Corpo: CF8M (acciaio inossidabile microfuso)
Leva: acciaio inossidabile A304
Componenti interni: acciaio inossidabile A304
Guarnizioni: PTFE

A RICHIESTA:

Attacchi NPT - Versione ottone (PN25).

FEATURES:

Full bore.
BSP threads.
Working pressure: 63 bar
Working temperature: -25°C / +180°C

Body: CF8M (micro-cast stainless steel)
Hand lever: stainless steel A304
Internal components: stainless steel A304
Seals: PTFE

UPON REQUEST:

NPT thread - Brass version (PN25).

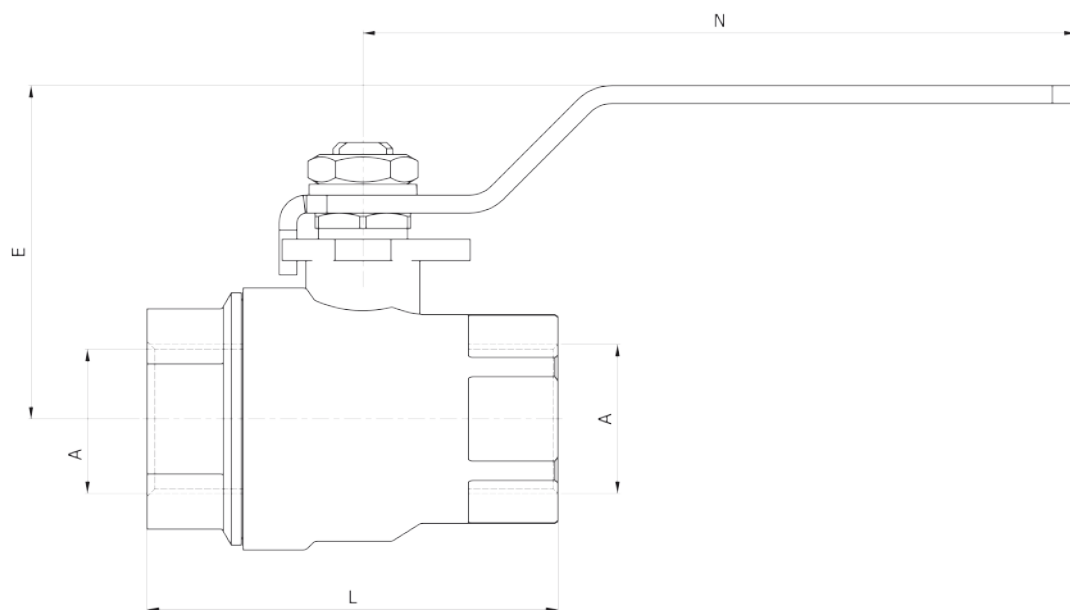

CODICE - CODES	A BSP	L	E	N	DN	PESO WEIGHT kg
SLE 120 1/4	1/4	50	50	104	8	0,192
SLE 120 3/8	3/8	50	50	104	10	0,192
SLE 120 1/2	1/2	55	51,5	104	15	0,205
SLE 120 3/4	3/4	70	62	122	20	0,445
SLE 120 1"	1"	83	65	122	25	0,608
SLE 120 1" 1/4	1" 1/4	91	82	180	32	1,150
SLE 120 1" 1/2	1" 1/2	103	88	205	40	1,150
SLE 120 2"	2"	120	106	219	50	1,620